

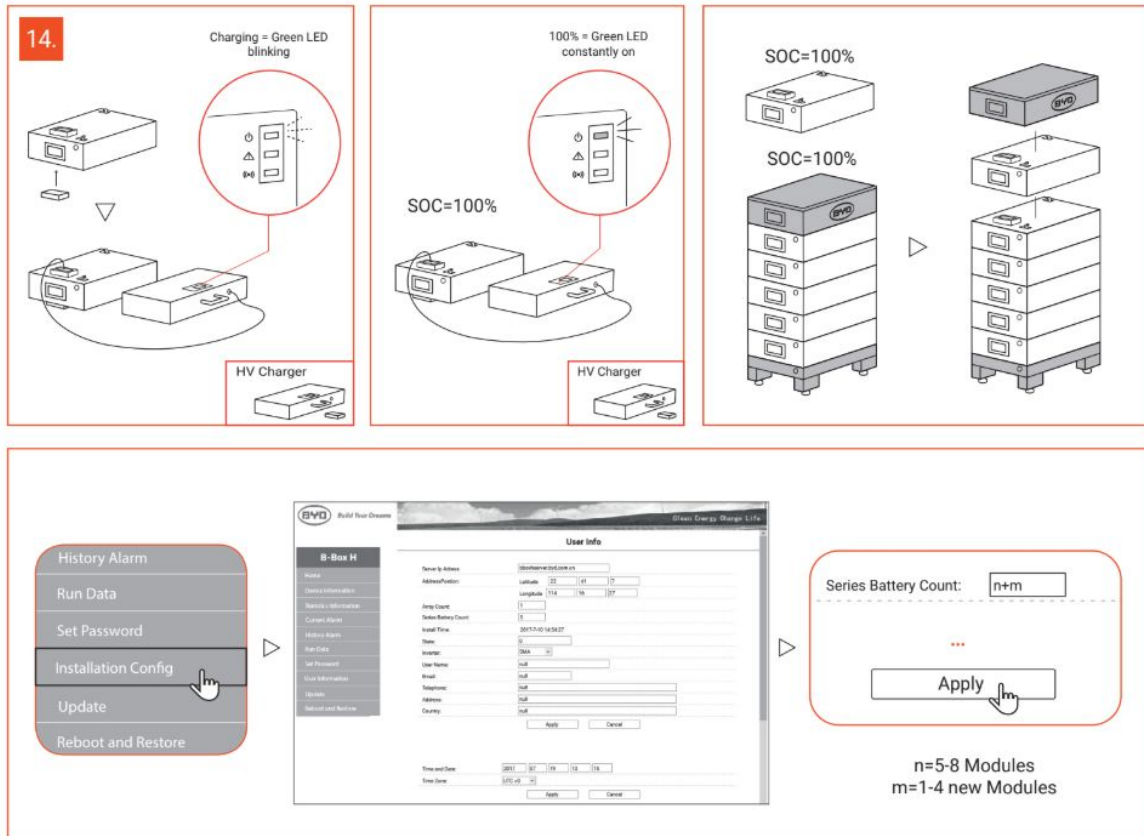

**Approach 2 (with charger):**

1. We send you a charger
2. Charge the new module to 100% SOC
  - Please note: The green LED of the charger will blink during the charging process. The charger will stop automatically and the green LED will be constantly on once the charging process is finished.*
3. Add the new module to the tower once the tower has 100%SOC
4. Adjust amount of modules in the web interface
5. Send the charger to the address we provide



This manual is a shortened assistance for the Battery-Box High Voltage and does not replace the original manual, which can be found on [www.eft-systems.de](http://www.eft-systems.de) or [www.byd.com](http://www.byd.com). The installation must be carried out by a qualified expert. Attention, High Voltage Storage! Improper handling can cause danger and damage.